



# Sofia<sup>®</sup> SARS Antigen FIA

## QUICK REFERENCE INSTRUCTIONS

For use with Sofia and Sofia 2.  
Rx only



Study the Package Insert and User Manual thoroughly before using Quick Reference Instructions. This is not a complete Package Insert.

For *in vitro* diagnostic use

**IMPORTANT!** Read instructions carefully before beginning. The test procedure below is unique to the Sofia SARS Antigen FIA and may differ from other Sofia and Sofia 2 FIA procedures.

### Test Procedure

All specimens must be at room temperature before testing.

**Expiration date:** Check expiration date on each individual test package or outer box before using. *Do not use any test past the expiration date on the label.*

Disposable gloves and safety glasses are recommended when running this test. Wash hands thoroughly after handling any patient sample.

### Swab Test Procedure (Nasal/Nasopharyngeal Swab)

1

Verify that Sofia or Sofia 2 is set to the desired Mode: **WALK AWAY** or **READ NOW**. See the “Using Sofia and Sofia 2” section for more information.

2

Dispense all of the Reagent Solution into the Reagent Tube. **Swirl the Reagent Tube to dissolve its contents.**

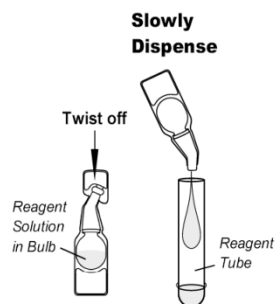

3

Place the patient swab sample into the Reagent Tube. Roll the swab at least 3 times while pressing the head against the bottom and side of the Reagent Tube.

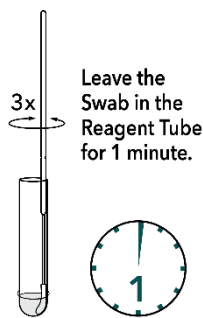

4

Roll the Swab head against the inside of the Reagent Tube as you remove it. Dispose of the used Swab in your biohazard waste.



5

Fill the provided **Small, Clear 120  $\mu$ L Fixed Volume Pipette** with patient sample from the Reagent Tube.

**To fill the Fixed Volume Pipette with the patient sample:**

- FIRMLY squeeze the top bulb.
- Still squeezing, place the Pipette tip into the sample.
- With the Pipette tip still in the sample, release pressure on bulb to fill the Pipette.

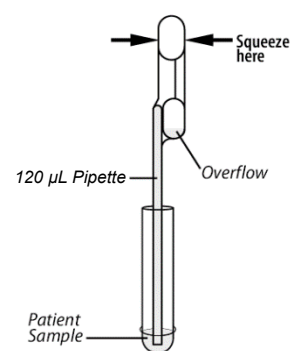

6

Firmly squeeze the top bulb to empty the contents of the **Small, Clear 120  $\mu$ L Fixed Volume Pipette** into the Test Cassette sample well. Extra liquid in the overflow bulb is OK.

**NOTE:** The Fixed Volume Pipette is designed to collect and dispense the correct amount of patient sample. Discard the Pipette in your biohazard waste.

**NOTE:** Do not pour sample from the Reagent Tube. Use the provided **Small, Clear 120  $\mu$ L Fixed Volume Pipette**.

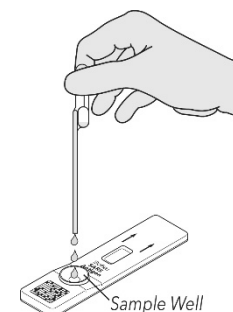

7

Proceed to the “Using Sofia and Sofia 2” section to complete the test.

1

Verify that Sofia or Sofia 2 is set to the desired Mode: **WALK AWAY** or **READ NOW**. See the “Using Sofia and Sofia 2” section for more information.

**NOTE: Only Copan UTM and CDC Formulation of VTM have been validated with the assay. Remel M4 and M4RT should not be used as some lots have been demonstrated to generate false positive results.**

2

Mix the specimen received in viral transport media by vortexing the tubes for 5 seconds.

3

Fill a calibrated micropipette with **250 µL** of patient sample from the Viral Transport Media (VTM).

**NOTE: Note: There is no need to dispense any reagent solution into the reagent tube. The patient sample in VTM will be used to rehydrate the reagent tube.**

**NOTE: To obtain accurate results, avoid mucoid substances when filling the micropipette with patient sample in VTM.**

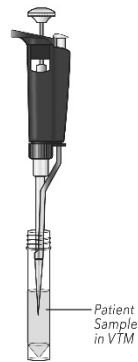

4

Empty the contents of the micropipette into the Reagent Tube.

**NOTE: Once the sample is added to the Reagent Tube, vortex the tubes for 5 seconds. Allow the sample to incubate for 1-minute prior to adding the sample to the Test Cassette.**

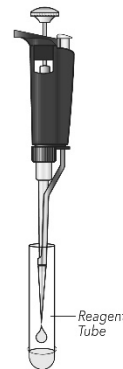

5

Fill the provided **Small, Clear 120 µL Fixed Volume Pipette** with patient sample from the Reagent Tube.

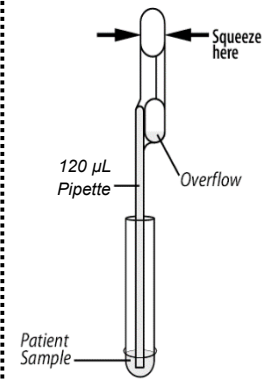

6

Firmly squeeze the top bulb to empty the contents of the **Small, Clear 120 µL Fixed Volume Pipette** into the Test Cassette sample well. Extra liquid in the overflow bulb is OK.

**NOTE: Do not pour sample from the Reagent Tube. Use the provided Small, Clear 120 µL Fixed Volume Pipette.**

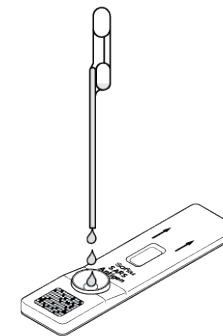

7

Proceed to the “Using Sofia and Sofia 2” section to complete the test.

# Using Sofia

## WALK AWAY/READ NOW Modes

Refer to the Sofia User Manual.

Sofia may be set to two different modes (WALK AWAY and READ NOW). The procedures for each mode are described below.

### WALK AWAY Mode

In WALK AWAY Mode, the user **immediately** inserts the Test Cassette into Sofia. Sofia will automatically time the test development, and the results will be displayed in 15 minutes.

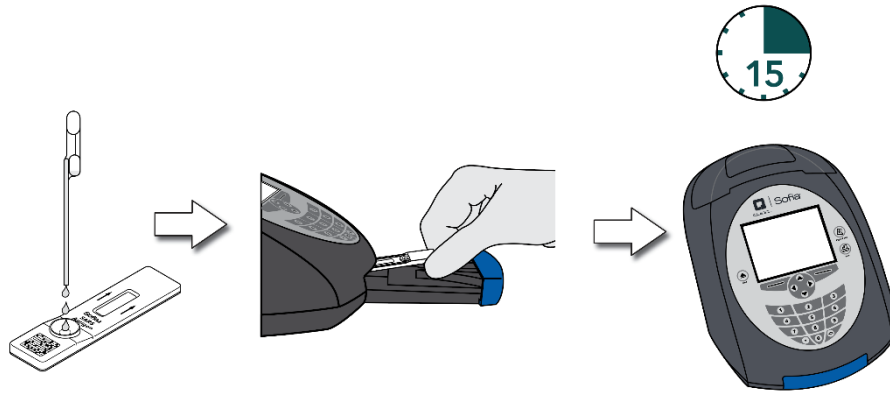

### READ NOW Mode

**Allow the test to develop for the FULL 15 minutes BEFORE placing it into Sofia.**

The user places the Test Cassette onto the counter or bench top for 15 minutes (outside of Sofia). The user manually times this development step. The Test Cassette **MUST** remain on the bench for 15 minutes to get an accurate result. Then, the user inserts the Test Cassette into Sofia. In READ NOW Mode, Sofia will scan and display the test result in 1 minute.

**Warning: Results must not be interpreted past 30 minutes after inoculation. Using the Sofia past this time may result in false results.**

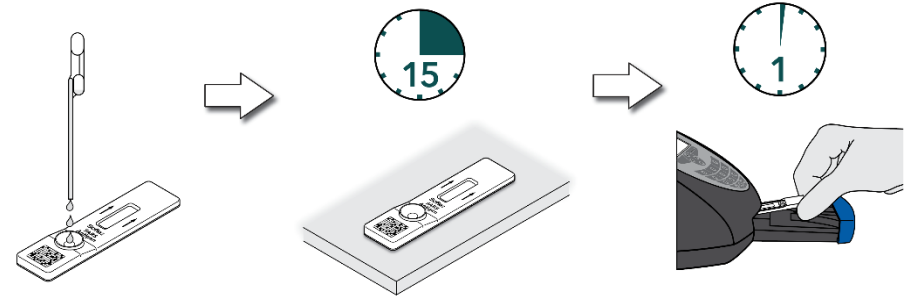

## RUN TEST

1. Input the User ID with the barcode scanner or enter the data using the key pad.

**NOTE:** If you scan the wrong barcode, use the Arrow Keys on Sofia to re-highlight the field and simply rescan using the correct barcode. The previous one will be overwritten with the right barcode.

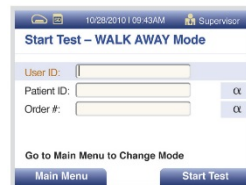

3. Press Start Test and the Sofia drawer will open.

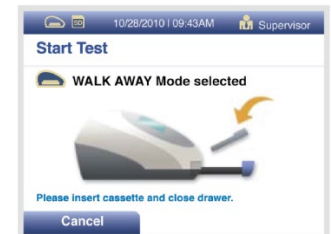

4. Verify that the correct mode (WALK AWAY or READ NOW) has been selected. Insert the Test Cassette into the drawer. Then gently close the drawer.

2. Input the Patient ID or Order # with the barcode scanner or enter the data using the key pad.

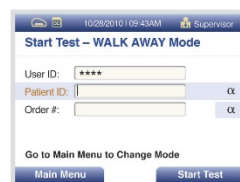

5. Sofia will start automatically and display the Mode, the test results will be displayed in approximately 15 minutes. In READ NOW Mode, the test results will be displayed in 1 minute. See Sofia Interpretation of Results section.

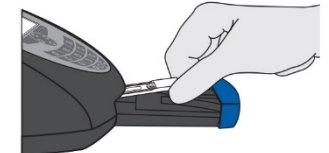

## Sofia Interpretation of Results

When the test is complete, the results will be displayed on the Sofia screen. The results can be automatically printed on the integrated printer if this option is selected. Test Lines will not be visible to the naked eye.

**Results:** The Sofia screen will display results for the procedural control as being “valid or invalid.” If the control is “invalid,” retest with a new patient sample and new Test Cassette.

Reader Display	Interpretation
SARS: Positive Procedural Control: Valid	Positive Test SARS (SARS Antigen present)
SARS: Negative Procedural Control: Valid	Presumptive Negative Test for SARS (no SARS antigen detected)
SARS: Procedural Control: Invalid	Result Invalid

## Sofia External Quality Control *(External Positive and Negative Swabs are supplied in the kit)*

1

From the main menu, select Run QC.



2

Follow the prompts on the screen. Scan the QC Card (located on the kit box).

3

Sofia prompts the user to select the desired mode (WALK AWAY or READ NOW). Run the External Control Swabs.

4

Follow the Swab Test Procedure of this Quick Reference Instructions. First test the Positive Swab, followed by the Negative Swab.

5

After both the Positive and Negative Swabs have been run, the results will be displayed as “Passed” or “Failed.”

# Using Sofia 2

## WALK AWAY/READ NOW Modes

Refer to the Sofia 2 User Manual.

Sofia 2 may be set to two different modes (WALK AWAY and READ NOW). The procedures for each mode are described below.

### WALK AWAY Mode

In WALK AWAY Mode, the user **immediately** inserts the Test Cassette into Sofia 2. Positive and negative test results will be displayed at 15 minutes.

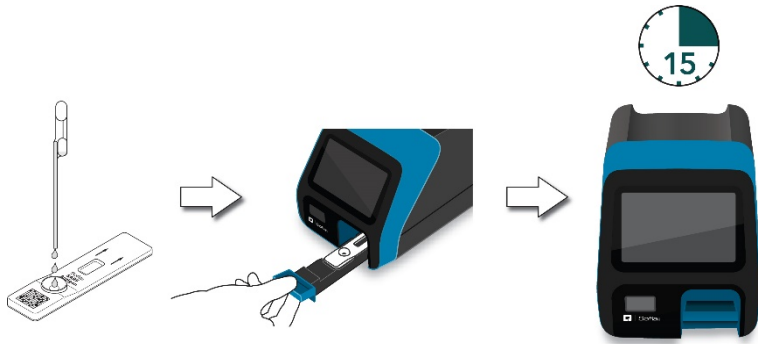

### READ NOW Mode

**Allow the test to develop for the FULL 15 minutes BEFORE placing it into Sofia 2.**

The user first places the Test Cassette onto the counter or bench top for 15 minutes (outside of Sofia 2). The user manually times this development step. The Test Cassette **MUST** remain on the bench for 15 minutes to get an accurate result. Then, the user inserts the Test Cassette into Sofia 2. In READ NOW Mode, Sofia 2 will scan and display the test result within 1 minute. **Warning: Results must not be interpreted past 30 minutes after inoculation. Using the Sofia past this time may result in false results.**

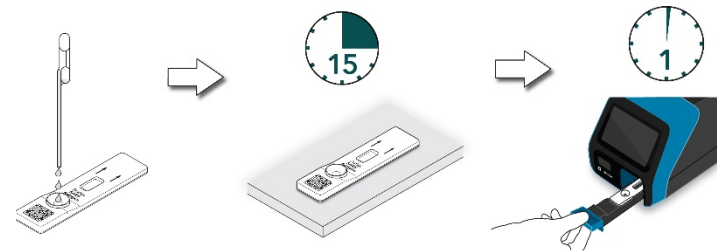

## RUN TEST

1. Input the User ID with the integrated barcode scanner or manually enter the data using the key pad.

**NOTE:** If you scan the wrong barcode, re-highlight the field using the touchscreen on Sofia 2. The previous one will be overwritten with the right barcode.

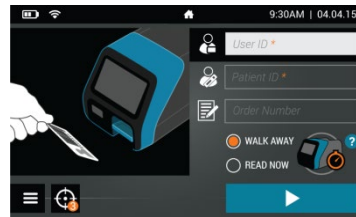

2. Input the Patient ID and Order # (if applicable) with the integrated barcode scanner or manually enter the data using the key pad.

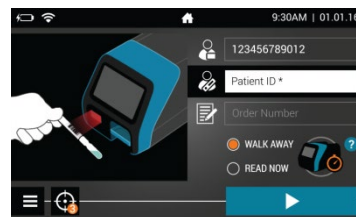

3. Verify that the correct mode (WALK AWAY or READ NOW) has been selected. Press ▶ and open the Sofia 2 drawer.

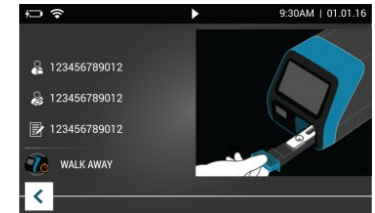









4. Insert the Test Cassette into the drawer. Then gently close the drawer.

5. Sofia 2 will start automatically and display the progress. In WALK AWAY Mode, the test results will be displayed in approximately 15 minutes. In READ NOW Mode, the test results will be displayed within 1 minute. See Sofia 2 Interpretation of Results section.

## Sofia 2 Interpretation of Results



When the test is complete, the results will be displayed on the Sofia 2 screen. Test Lines will not be visible to the naked eye.

**Results:** The Sofia 2 screen will display results for the procedural control as being  or . If the control is , retest with a new patient sample and new Test Cassette.

Reader Display	Interpretation
SARS:  Procedural Control: 	Positive Test for SARS (SARS antigen present)
SARS:  Procedural Control: 	Presumptive Negative Test for SARS (no SARS antigen detected)
SARS: Procedural Control: 	Result Invalid

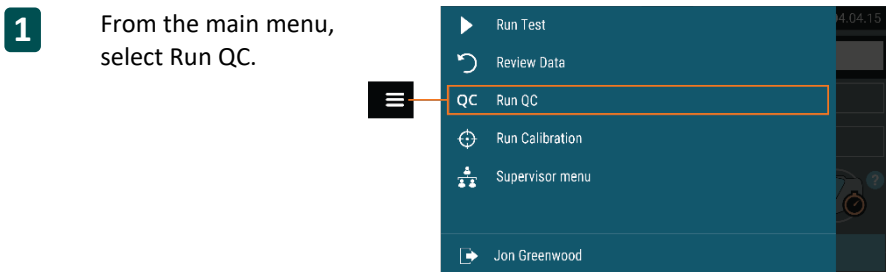
## Sofia 2 External Quality Control *(External Positive and Negative Swabs are supplied in the kit)*



- 2 Follow the prompts on the screen. Scan the QC Card (located on the kit box).
- 3 Sofia 2 prompts the user to select the desired mode (WALK AWAY or READ NOW). Run the External Control Swabs.
- 4 Follow the Swab Test procedure of this Quick Reference Instructions. First test the Positive Swab, followed by the Negative Swab.
- 5 After both the Positive and Negative Swabs have been run, the results will be displayed as  or .

### INTENDED USE

The Sofia SARS Antigen FIA is a lateral flow immunofluorescent sandwich assay that is used with the Sofia and Sofia 2 instrument intended for the qualitative detection of the nucleocapsid protein antigen from SARS-CoV-2 in nasopharyngeal (NP) and nasal (NS) swab specimens directly or after the swabs have been added to either Copan UTM or the CDC's formulation of VTM from individuals who are suspected of COVID-19 by their healthcare provider.

The Sofia SARS Antigen FIA does not differentiate between SARS-CoV and SARS-CoV-2.

Results are for the identification of SARS-CoV-2 nucleocapsid protein antigen. Antigen is generally detectable in upper respiratory specimens during the acute phase of infection. Positive results indicate the presence of viral antigens, but clinical correlation with patient history and other diagnostic information is necessary to determine infection status. Positive results do not rule out bacterial infection or co-infection with other viruses. The agent detected may not be the definite cause of disease. Laboratories within the United States and its territories are required to report all positive results to the appropriate public health authorities.

**Negative results should be treated as presumptive and confirmed with a molecular assay, if necessary for patient management. Negative results do not rule out COVID-19 and should not be used as the sole basis for treatment or patient management decisions, including infection control decisions.** Negative results should be considered in the context of a patient's recent exposures, history and the presence of clinical signs and symptoms consistent with COVID-19.

The Sofia SARS Antigen FIA is intended for use by medical professionals or trained operators who are proficient in performing tests using the Sofia and Sofia 2 Instrument.

Reference the Package Insert for *Warnings and Precautions, Limitations, Specimen Collection and Handling, and*

### ASSISTANCE

If the Sofia, Sofia 2 or the assay do not perform as expected, contact Quidel Technical Support 800.874.1517 (in the U.S.), 858.552.1100 (outside the U.S.), technicalsupport@quidel.com, or your local distributor.



Study the Package Insert and User Manual thoroughly before using Quick Reference Instructions. This is not a complete Package Insert.



Quidel Corporation  
San Diego, CA 92121 USA  
quidel.com

1452000EN00 (06/20)